



Installation and Operation Instructions HeatBloC® K32 - DN 20

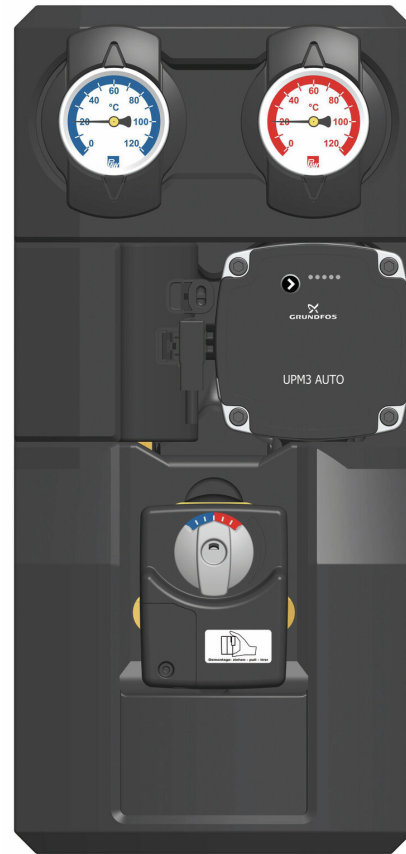
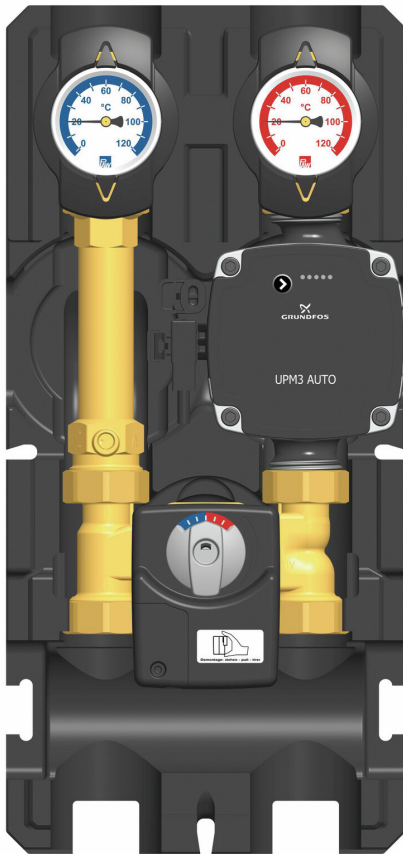

Table of Contents

1	General Information.....	3
1.1	Scope of these instructions.....	3
1.2	Designated use.....	3
2	Safety instructions.....	4
3	Product description.....	5
3.1	Equipment.....	5
3.2	Function.....	6
3.2.1	3-way mixing valve [specialist].....	7
3.2.2	Pump [specialist].....	10
3.2.3	Check valve.....	11
3.2.4	Accessories: Actuator (optional).....	12
4	Mounting and installation [specialist].....	13
4.1	Installation of the modular distribution manifold / of the wall bracket with mounting plate.....	13
4.2	Installation and commissioning of the HeatBloC®	14
4.3	Accessories: Cutting-ring compression fitting (not included in the scope of delivery).....	16
5	Scope of delivery [specialist].....	17
6	Technical data.....	19
6.1	Pressure drop and pump characteristic curves.....	20
7	Disposal.....	21
8	Notes.....	22

1 General Information



Carefully read these instructions before installation and commissioning.

Save these instructions in the vicinity of the installation for future reference.

1.1 Scope of these instructions

These instructions describe the installation, commissioning, functioning and the operation of a mixed HeatBloC®.

For other components of the installation, such as the pump, the controller or the modular distribution manifold, please observe the instructions of the corresponding manufacturer. The chapters called [specialist] are intended for specialists only.

1.2 Designated use

The product may only be used in heating circuits taking into consideration the technical limit values indicated in these instructions.

It must **not** be used in drinking water applications.

Improper usage excludes any liability claims.

This product complies with the relevant directives and is therefore labelled with the CE mark.

The Declaration of Conformity is available upon request, please contact the manufacturer.



Only use PAW accessories with the product.

2 Safety instructions

The installation and commissioning as well as the connection of electrical components require technical knowledge commensurate with a recognised vocational qualification as a fitter for plumbing, heating and air conditioning technology, or a profession requiring a comparable level of knowledge [specialist].

The following must be observed during installation and commissioning:

- relevant local and national regulations
- accident prevention regulations of the professional association
- instructions and safety instructions mentioned in these instructions

 CAUTION	
	<p>Personal injury and damage to property!</p> <p>The product must only be used in heating circuits filled with heating water according to VDI 2035 / Ö-Norm H 5195-1.</p> <ul style="list-style-type: none"> ▶ The product must not be used in drinking water applications.

NOTICE	
<p>Material damage due to mineral oils!</p> <p>Mineral oil products cause lasting damage to seals made of EPDM, whereby the sealant properties are lost. We do not assume liability nor provide warranty for damage to property resulting from sealants damaged in this way.</p> <ul style="list-style-type: none"> ▶ It is imperative to prevent the EPDM sealing elements from making contact with substances containing mineral oils. ▶ Use a silicone- or polyalkylene-based lubricant free of mineral oil such as Unisilikon L250L and Syntheso Glep 1 from Klüber or a silicone spray. 	

3 Product description

3 Product description

The HeatBloC® is a preassembled group of fittings for heating circuits. The pump can be isolated by means of the ball valves and the mixing valve. The pump can thus be maintained easily without draining the heating circuit system.

The PAW HeatBloC® is designed such that it can be directly mounted onto a distribution manifold or a mounting plate. With adaptor connections, PAW HeatBloC®s can also be installed on distribution manifolds with other dimensions.

3.1 Equipment

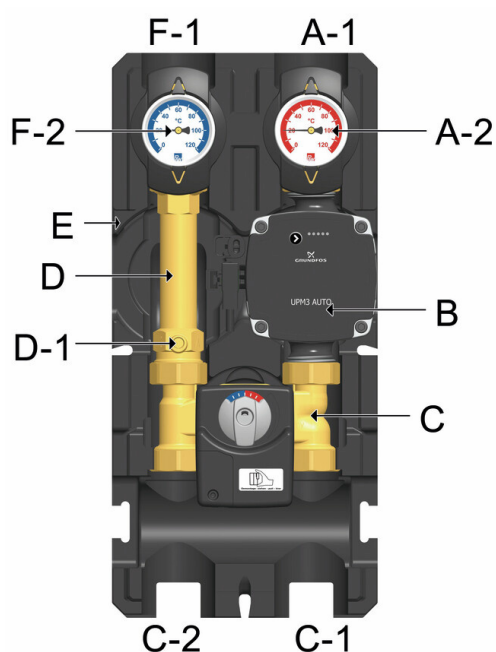

- A-1 Flow to the consumer circuit
- A-2 All-metal thermometer with immersion sleeve, integrated in the ball valve (flow)
- B Heating pump
- C 3-way mixing valve
- C-1 Flow from the heat generator
- C-2 Return to the heat generator
- D Return pipe
- D-1 Check valve, can be opened
- E Design insulation with optimised function
- F-1 Return from the consumer circuit
- F-2 All-metal thermometer with immersion sleeve, integrated in the ball valve (return)

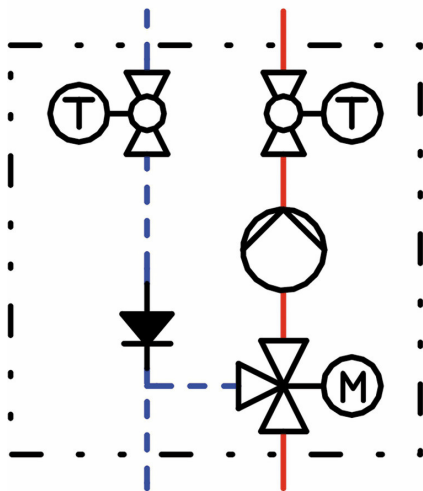
3.2 Function

K32 - HeatBloC® with 3-way mixing valve

The flow temperature of the heating circuit is controlled by the integrated mixing valve. Hot water from the boiler and cold return water are mixed to obtain the desired flow temperature of the heating circuit. The mixing valve is adjusted via an external controller in combination with an electric actuator. The ball valves allow a maintenance of the pump, of the boiler / heat generator circuit as well as of the consumer circuit without putting the entire installation out of operation. Two thermometers display the temperatures of the flow and the return and allow thus a function control. The integrated check valve can be opened, it avoids an unwanted circulation and can be put out of operation to flush and fill the installation. The insulation avoids that heat energy gets lost.

Application range:

- Installations with several HeatBloC®s and different flow temperatures (radiators and radiant floor heating)
- Installations with high fluctuations of the flow temperature due to the heat generator (solid fuel boilers, installations with power-heat cogeneration)

3 Product description

3.2.1 3-way mixing valve [specialist]

The 3-way mixing valve (C), driven by an electric actuator, adjusts the flow temperature of the consumer circuit to the required value by means of the flow sensor and the controller.

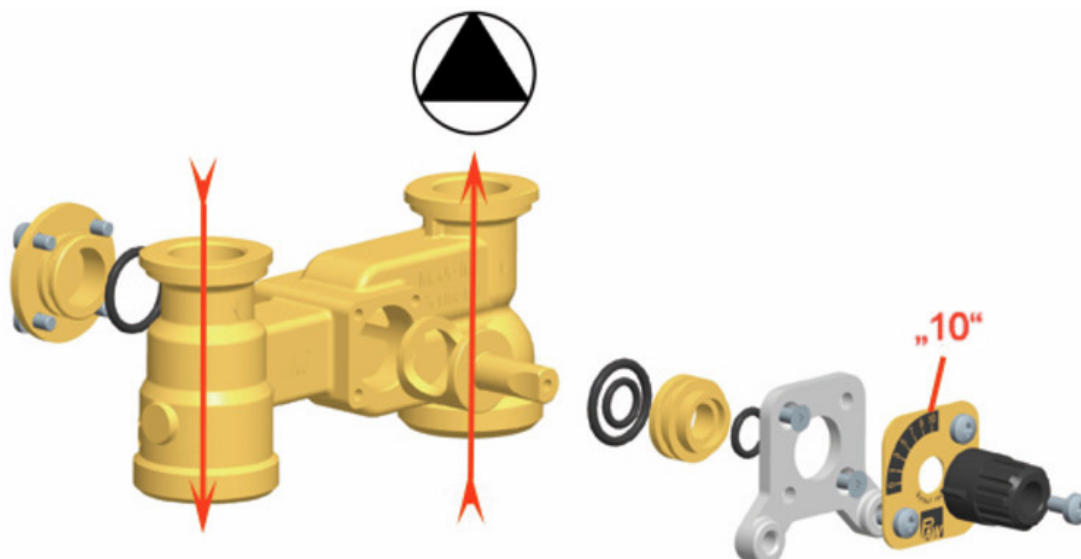

Position 10: passage, no mixing

flow temperature consumer = flow temperature heat generator

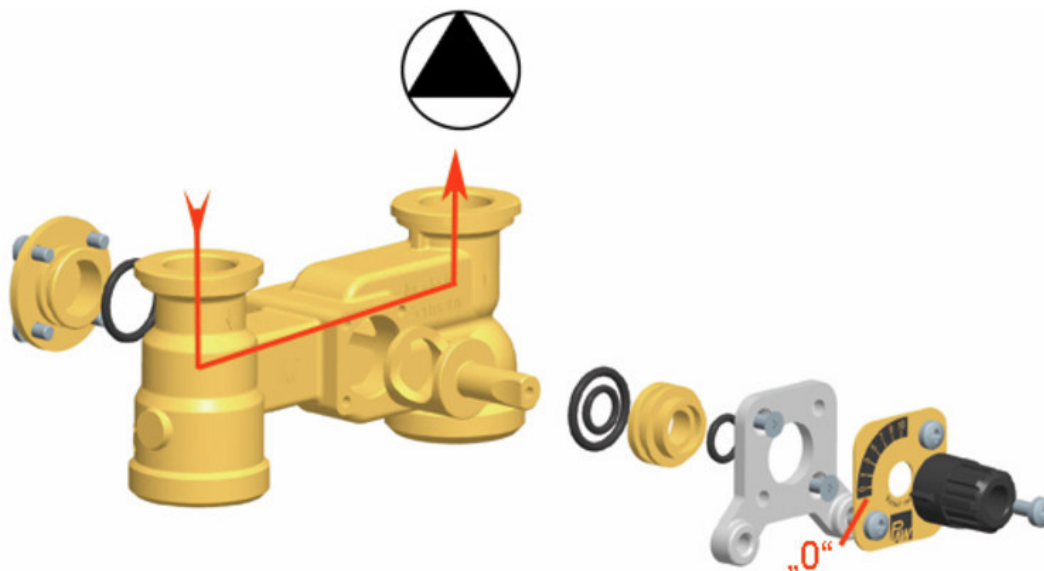

Position 0: 100 % mixing

flow temperature consumer = return temperature consumer

Change of the flow line [specialist]
Dismounting of the mixing valve

1. Take off the thermometer handles (A-2, F-2) and remove the insulating front shell.
2. Take the group of fittings out of the insulating back shell.
3. Dismount the mixing valve (C).

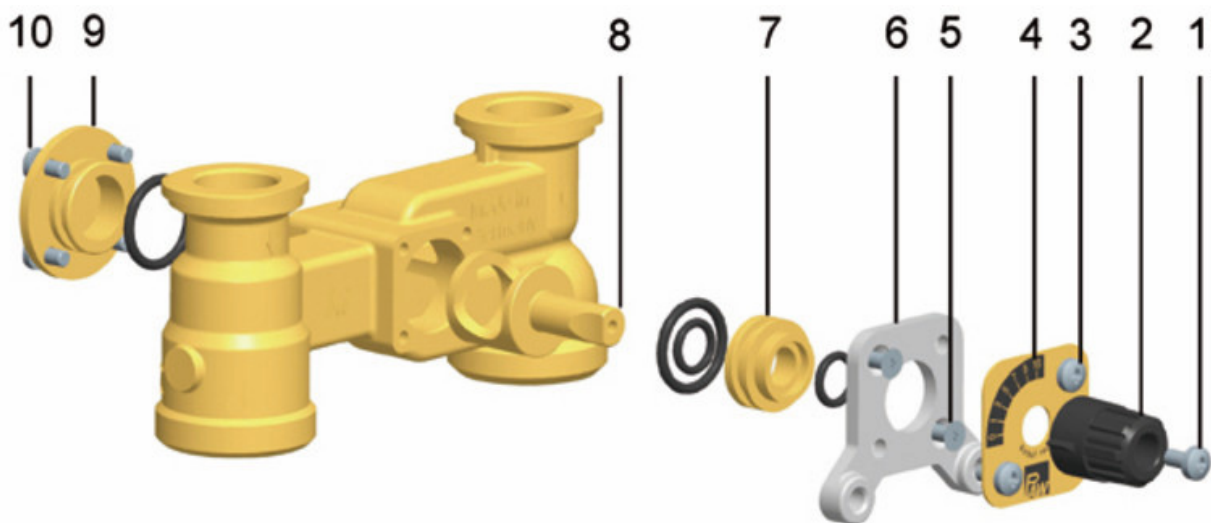
Retrofitting of the mixing valve

1. Loosen the screw (1).
2. Take off the rotary knob (2) from the cock rod.
3. Loosen the screws (3).
4. Remove the cover plate (4).
5. Loosen the two screws (5).
6. Remove the front plate (6).
7. Extract the sealing bush (7) with the cock plug (8) from the housing of the mixing valve.
8. Loosen the screws on the rear side of the mixing valve (10).
9. Take off the cover (9) on the rear side of the mixing valve and fix it on the other side of the mixing valve by using the screws (10).
10. Insert the sealing bush (7) with the cock plug (8) into the channel of the mixing valve.

3 Product description

11. Screw down the front plate (6) using the screws (5).

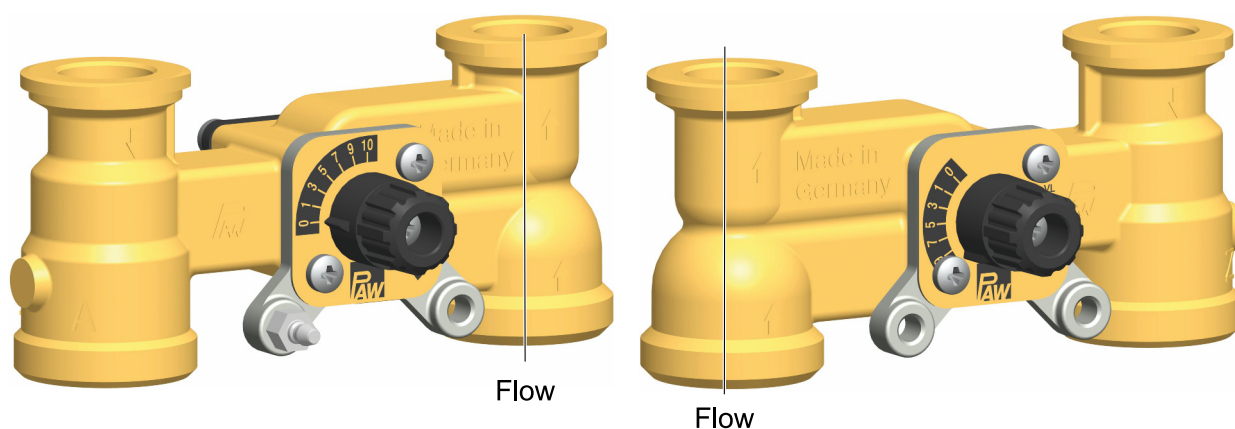

Mixing valve with flow on the right

Mixing valve with flow on the left

12. Turn the cover plate (4) in such a way that the marking PAW is at the bottom and that the scale is positioned as shown in the figure above.
13. Fix the cover plate (4) by using the screws (3).
14. Put the rotary knob (2) onto the cock rod.
15. Fix the rotary knob (2) on the cock plug (8) by using the screw (1).

Retrofitting and commissioning of the HeatBloC®

1. Interchange the return pipe (D) and the flow pipe with the pump (B).

Consider the flow direction of the pump!

Turn the pump head such that the terminal box is directed to the top or to the centre of the group of fittings.

2. Dismount and interchange the ball valves.
3. Mount the heating circuit and connect it to the installation.
4. Check all union nuts before commissioning and firmly tighten them if necessary.
5. Mount the insulation only after having carried out a pressure test. Mount the thermometer handles (A-2, F-2) in a final step.

3.2.2 Pump [specialist]

The pump can be completely isolated. It can be replaced and maintained without draining the heating circuit system.

Isolation of the pump

1. Close the ball valves in the flow and the return (A-2, F-2).
2. Remove the actuator from the mixing valve.
3. Turn the rotary knob of the mixing valve such that the black nose is directed to "VL zu" (flow closed).
4. Cut off the expansion tank to depressurise the installation. The mixing valve is now closed and drop tight. The pump can be dismantled.

3 Product description

3.2.3 Check valve

The product is equipped with a check valve in the return pipe. The check valve can be opened.

Operation

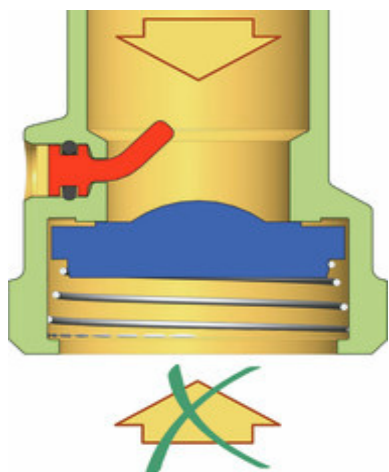

During operation, the marking must be directed to "Z".

- The check valve is closed.
- Flow only in the direction of the arrow.



Filling, draining, venting

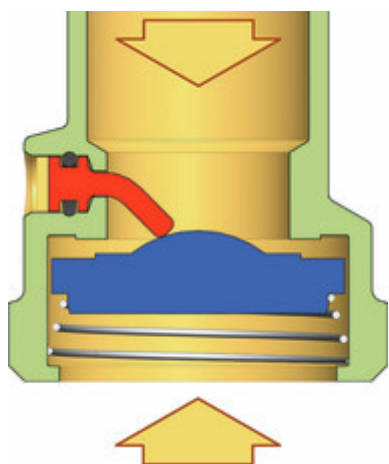

For filling, draining and venting the installation, the marking must be directed to "A".

- The check valve is open.
- Flow in both directions.



3.2.4 Accessories: Actuator (optional)

The PAW actuator for weather-compensated control is available as an accessory.

For mixing valves with flow on the left, the scale must be turned by 180°.

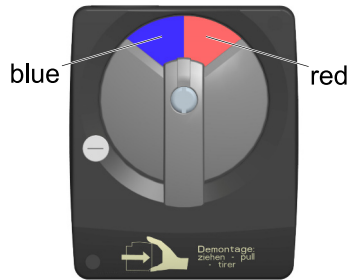

For mixing valve with flow on the right

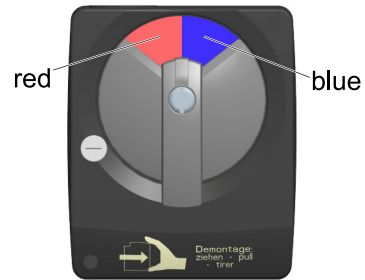

For mixing valve with flow on the left



Assembly of the actuator - flow on the right:

If the PAW actuator has been purchased as an optional accessory, the mixing valve contains a metal plate. To mount the PAW actuator on the mixing valve, proceed as follows:

1. Dismount the rotary knob of the mixing valve.
2. Mount the rotary knob delivered with the actuator.
3. Turn the rotary knob to **Position 0**.
4. Set the actuator to manual mode by turning the selector switch.
5. Turn the rotary knob of the actuator to the left to the position shown on the adjacent figure.
6. Put the actuator on the adjusting knob of the mixing valve and the two stop bolts.
7. Set the actuator to automatic mode.

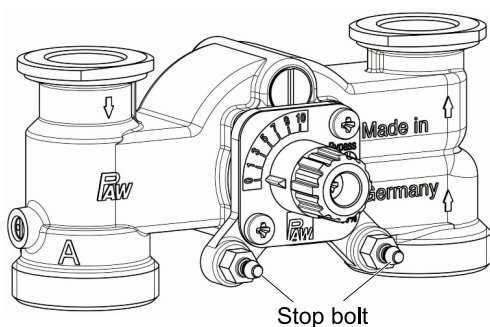

4 Mounting and installation [specialist]

The HeatBloC® can be mounted on a distribution manifold or on a wall bracket with mounting plate. The distribution manifold, the wall bracket and the mounting plate are not included in the scope of delivery.

NOTICE

Damage to property!

The installation site must be dry, stable, frost-proof and protected against ultraviolet radiation in order to prevent material damage of the installation.

4.1 Installation of the modular distribution manifold / of the wall bracket with mounting plate

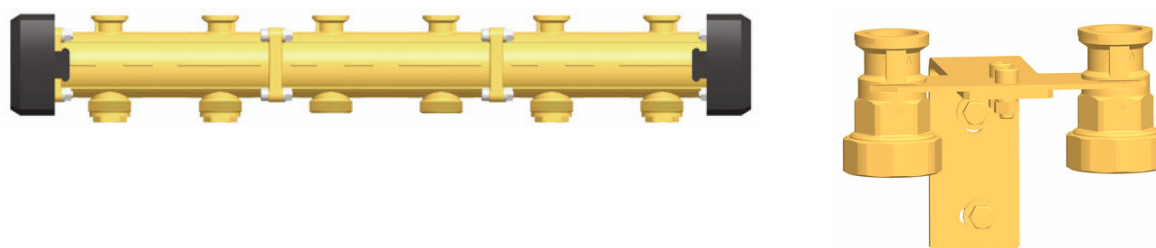

Mount the modular distribution manifold or the wall bracket with mounting plate as described in the separate instructions.

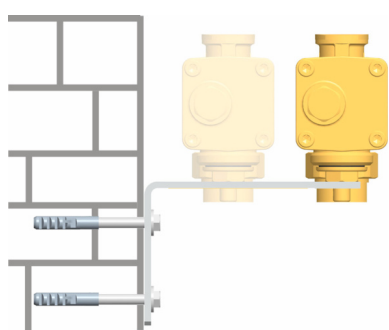

If possible, choose the mounting holes with the largest distance to the wall. It is thus easier to mount the insulation of the modular distribution manifold.

4.2 Installation and commissioning of the HeatBloC®

The HeatBloC® can be mounted

Option 1:

on a PAW modular distribution manifold.

Option 2:

on a mounting plate with transition thread connections.

Consumer circuit
return flow



flow return
Heat generator

Consumer circuit
return flow

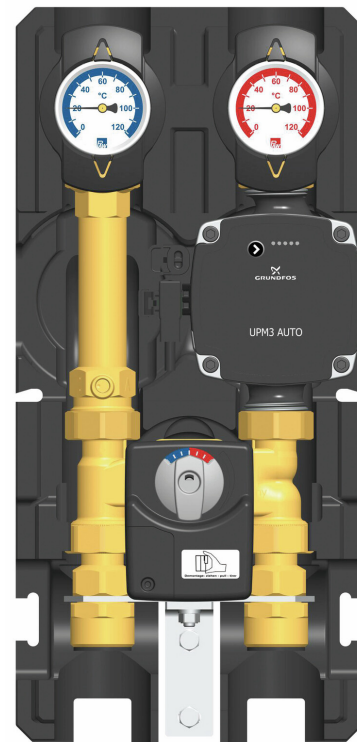

return flow
Heat generator

4 Mounting and installation [specialist]

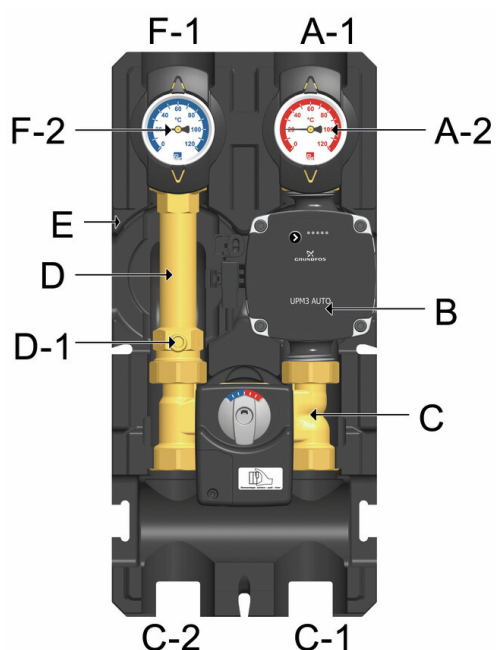
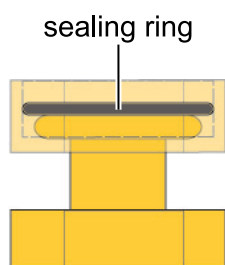
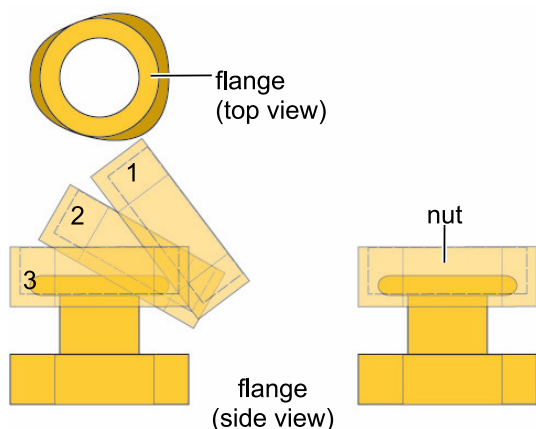

1. Take off the thermometer handles (A-2, F-2) and remove the insulating front shell of the HeatBloC®.
2. Unscrew the nuts on the lower connections of the HeatBloC® and take out the sealing rings.
3. Put the two nuts over the flanges.
4. Insert the sealing rings into the nuts.
5. Put the HeatBloC® onto the two nuts.
6. Tighten the nuts. Make sure that the nuts do not get jammed and that the sealing rings do not slip.
7. Connect the HeatBloC® to the installation by using the pipes. The installation to the piping must be carried out without any tension.
8. Connect the pump.
9. Carry out a pressure test and check all thread connections.
10. Mount the insulating front shell and the thermometer handles (A-2, F-2).

4.3 Accessories: Cutting-ring compression fitting (not included in the scope of delivery)

The connection to the heating installation can be carried out fast, pressure-proof and without soldering if you use the optionally available compression fittings.

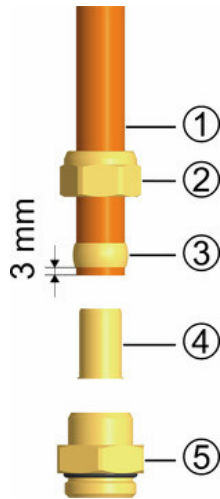

Not included in the scope of delivery!

1. Push the union nut ② and the cutting ring ③ onto the copper pipe ①. The pipe must protrude at least 3 mm from the cutting ring in order to ensure the force transmission and the sealing.
2. Insert the support sleeve ④ into the copper pipe.
3. Insert the copper pipe with the plugged-on individual parts ②, ③ and ④ as far as possible into the body of the compression fitting ⑤.
4. First, screw the union nut ② manually.
5. Tighten the union nut ② by rotating one full turn. Secure the body of the compression fitting ⑤ against distort in order to avoid damaging the sealing ring.

5 Scope of delivery [specialist]

NOTICE

Serial number

Complaints and requests/orders of spare parts will only be processed with information on the serial number! The serial number is placed on the return pipe of the product.

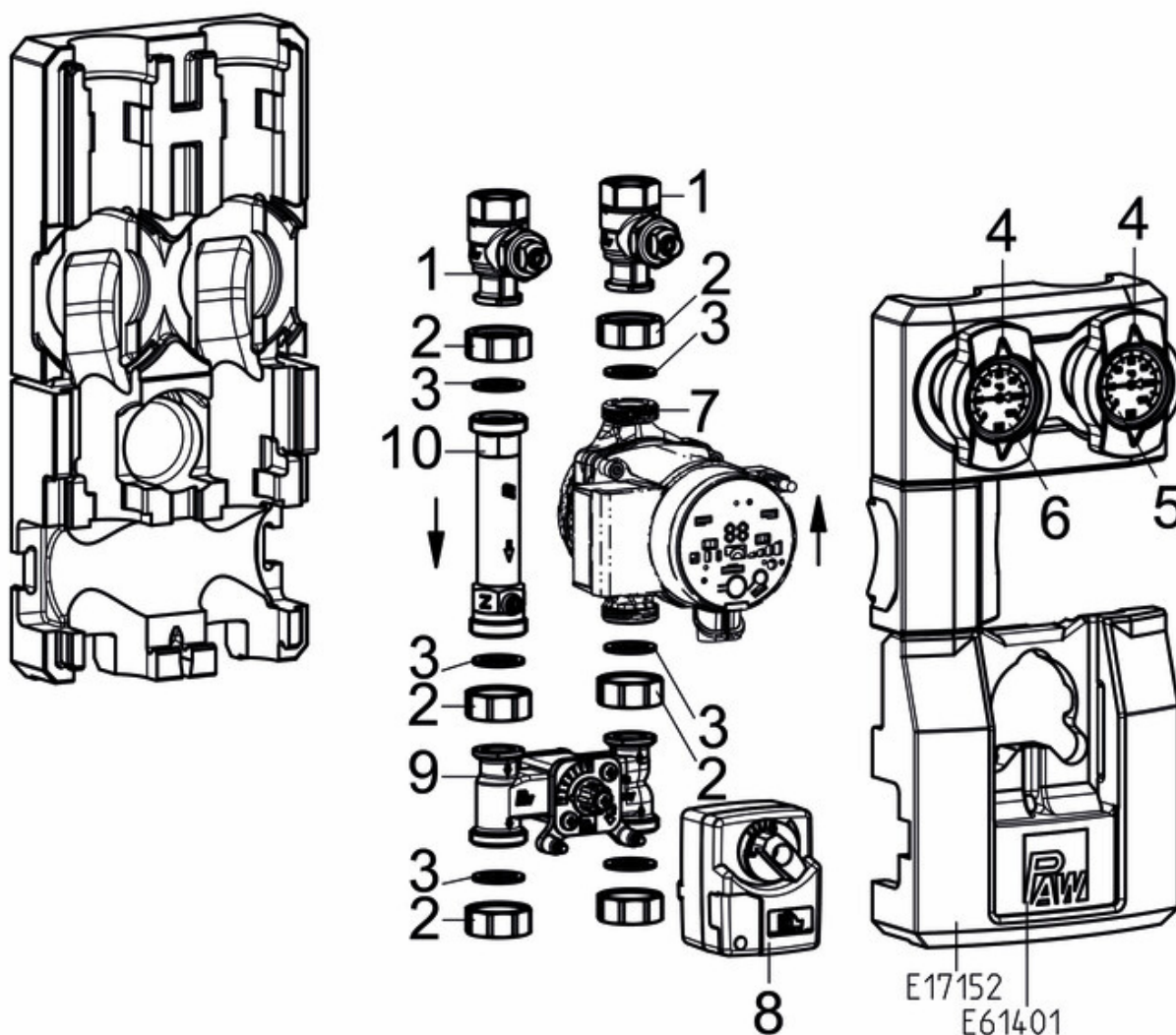

Position	Spare part	Item number
1	Thermometer ball valve DN 20, F ½" x ¾" int. thread	N00202
2	Union nut G 1"	N00302
3	Gasket ½", for threaded connection 1", 10 pieces	N00129
4	Thermometer handle for thermometer ball valve 1"	N00248
5	Dial thermometer, red scale, d = 50 mm, 0-120 °C	N00242
6	Dial thermometer, blue scale, d = 50 mm, 0-120 °C	N00243
7	Pump see following table	
8	Actuator SR2, 230 V AC, 2 Nm, 105 s/90°	N00070
9	3-way mixing valve DN 20, F¾" x 1" ext. thread	N00043
10	Brass pipe DN 20, 2x 1" ext. thread x 130 mm, with check valve	N00141

Item no. heating circuit*	Pump	Item no. pump	EEl
32053(M)WP6	Wilo Para 15/6-43	N00258	< 0.20
32053(M)WN06	Wilo Yonos PICO 15/1-6	N00315	< 0.20
32053(M)GM6	Grundfos UPM3 Auto L 15-70 PP3	N00333	< 0.20
32053(M)GH6	Grundfos Alpha2.1 15-60	N00336	< 0.17

*Heating circuits with an actuator additionally contain a M in the item number, e. g. 32053**M**WP6
(without actuator = 32053WP6)

6 Technical data

HeatBloC® K32 DN 20 (3/4")	
Dimensions	
Centre distance (1)	90 mm
Width insulation (2)	180 mm
Height insulation (3)	385 mm
Installation length (4)	255 mm
Connections	
Outlet (A-1, F-1)	3/4" internal thread
Inlet (C-1, C-2)	1" external thread
Operating data	
Max. pressure	6 bar
Max. temperature	110 °C
K _{VS} value [m ³ /h]	3.7
Opening pressure check valve (D-1)	200 mm wc, can be opened

HeatBloC® K32 DN 20 (¾")	
Materials	
Valves and fittings	Brass
Seals	EPDM / NBR
Insulation	EPP

6.1 Pressure drop and pump characteristic curves

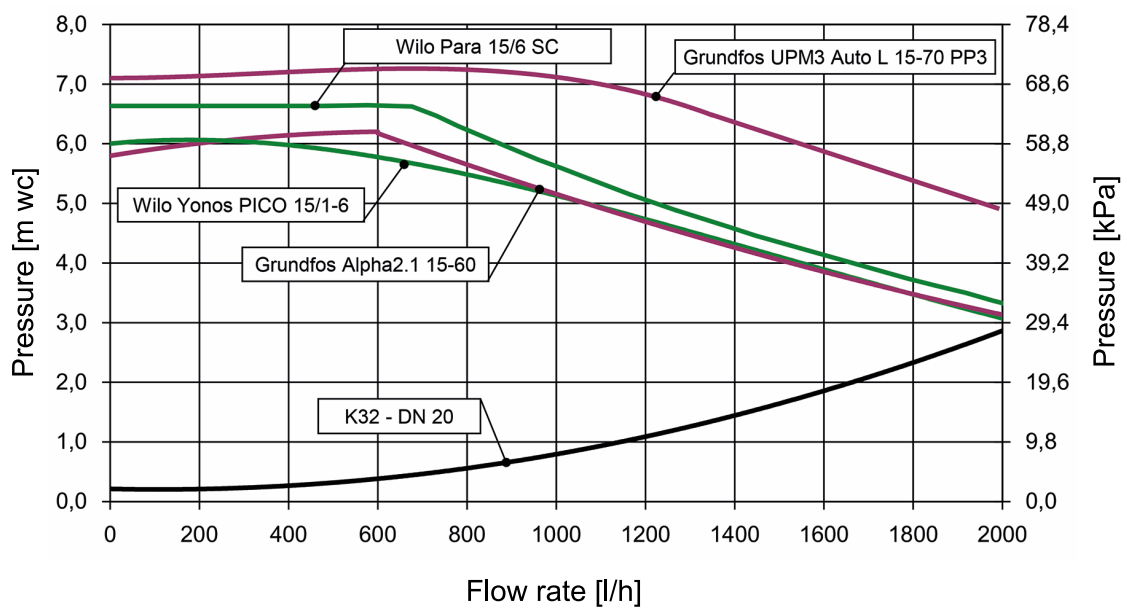

7 Disposal

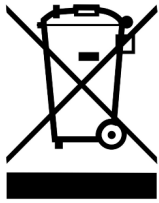
NOTICE	
	<p>Electrical and electronic devices must not be disposed of in the household waste.</p> <p>For your return, there are free collection points for electrical appliances and, if necessary, additional points of acceptance for the reuse of the devices in your area. The addresses can be obtained from your city or communal administration.</p> <p>If the old electrical or electronic device contains personal data, you are responsible for deleting it before returning the device.</p> <p>Batteries and rechargeable batteries must be removed prior to the disposal of the product. Depending on the product equipment (partly with optional accessories), single components can also contain batteries and rechargeable batteries.</p> <p>Please observe the disposal symbols on the components.</p>

Disposal of transport and packaging materials

The packaging materials are made of recyclable materials and can be disposed of with recyclable materials.



8 Notes



Item no. 9932053x-mub-en

Translation of the original instructions

We reserve the right to make technical changes without notice!

Printed in Germany - Copyright by PAW GmbH & Co. KG

PAW GmbH & Co. KG

Böcklerstraße 11

31789 Hameln, Germany

www.paw.eu

Phone: +49-5151-9856-0

Fax: +49-5151-9856-98